



## M2 / Engine Dynamometer



### M2 Water Brake Dynamometer

#### Specifications

Power: 50 hp (37 kW)

Torque: 68 ft-lb (92 N)

Speed: 6,000 rpm

Water Use: 10 gpm (38 lpm) (No Cooling System)

Shipping Weight: 150 lb (68 kg)

#### Recommended Accessories

- Driveshaft
- Shaft Guard
- Test Stand
- Data Acquisition & Control System
- Water Recirculating System

# Optional Accessories

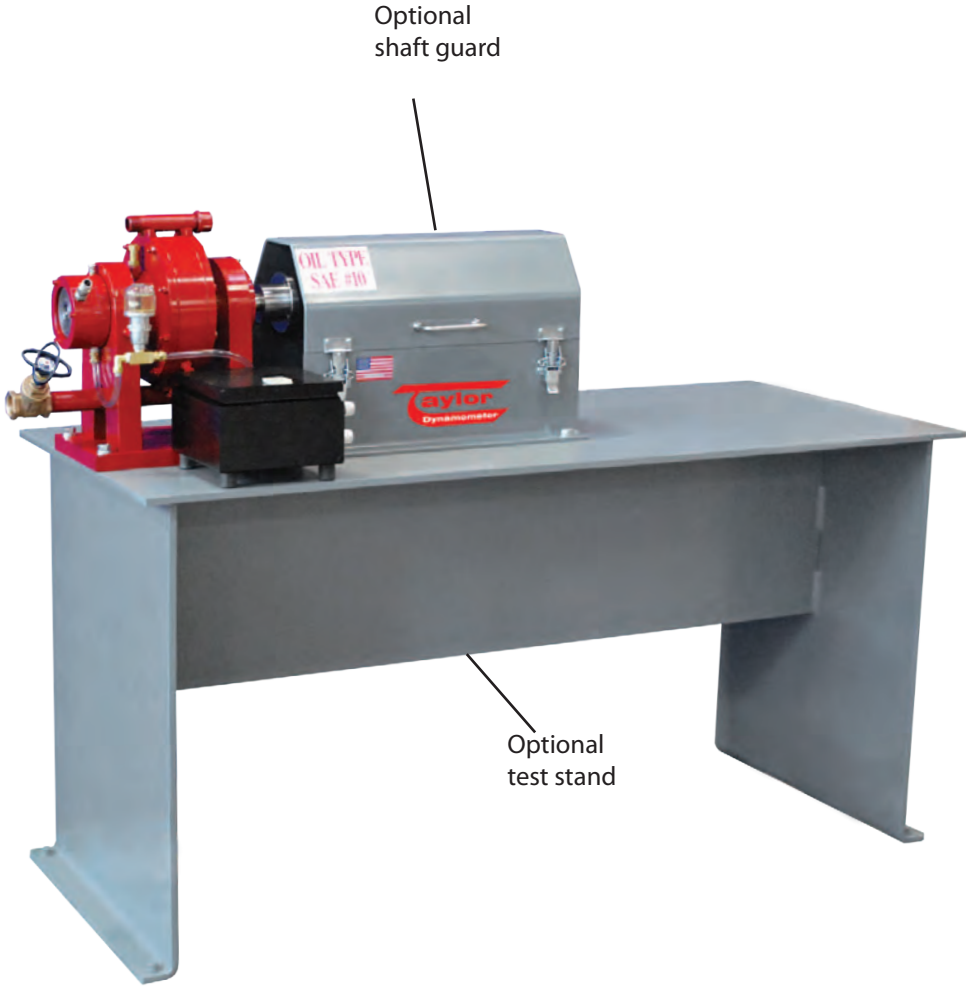

Optional shaft guard

Optional test stand

M2 shown above with available options

Optional Driveshaft



Optional DynTek PC

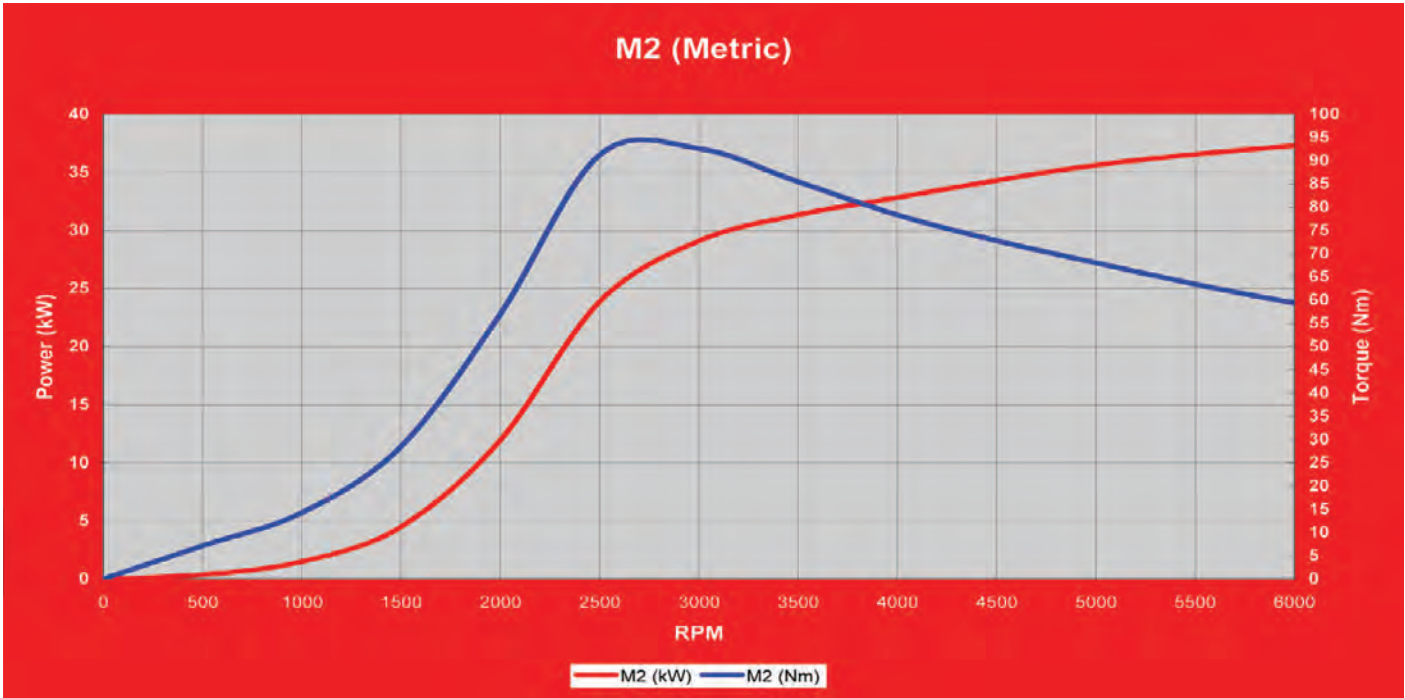
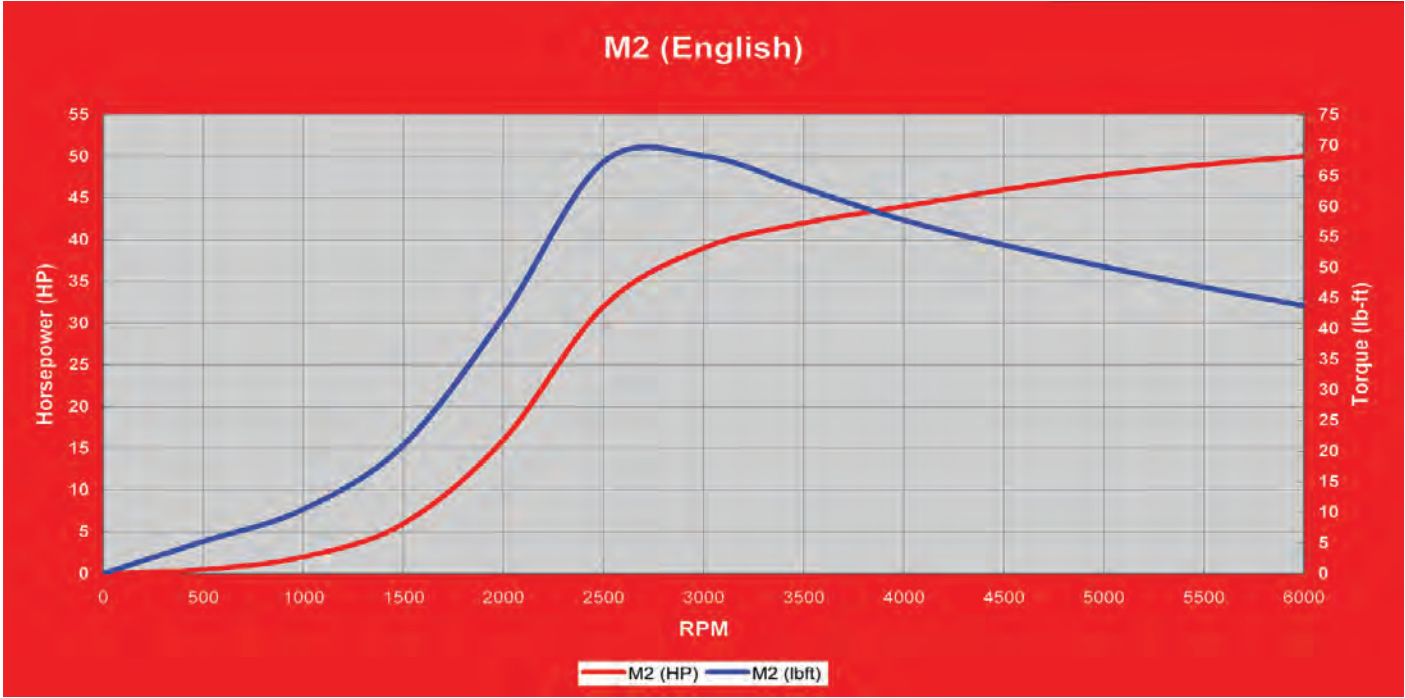

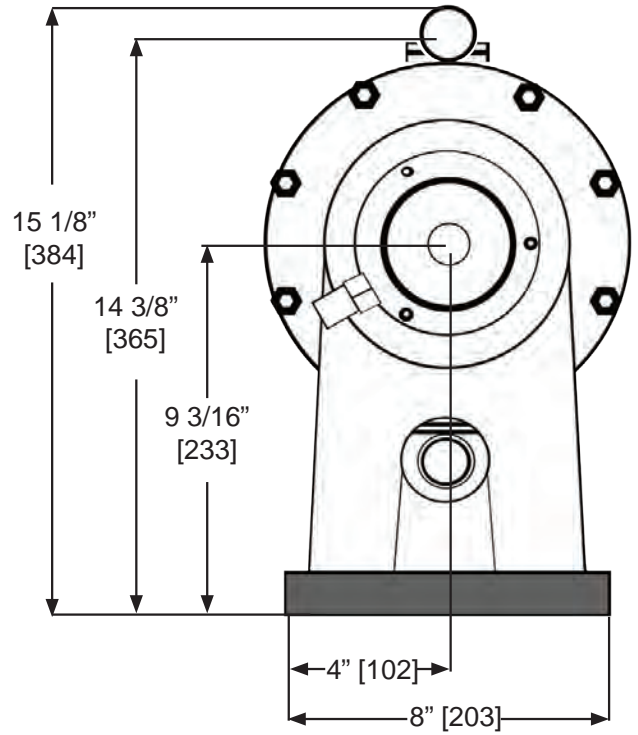
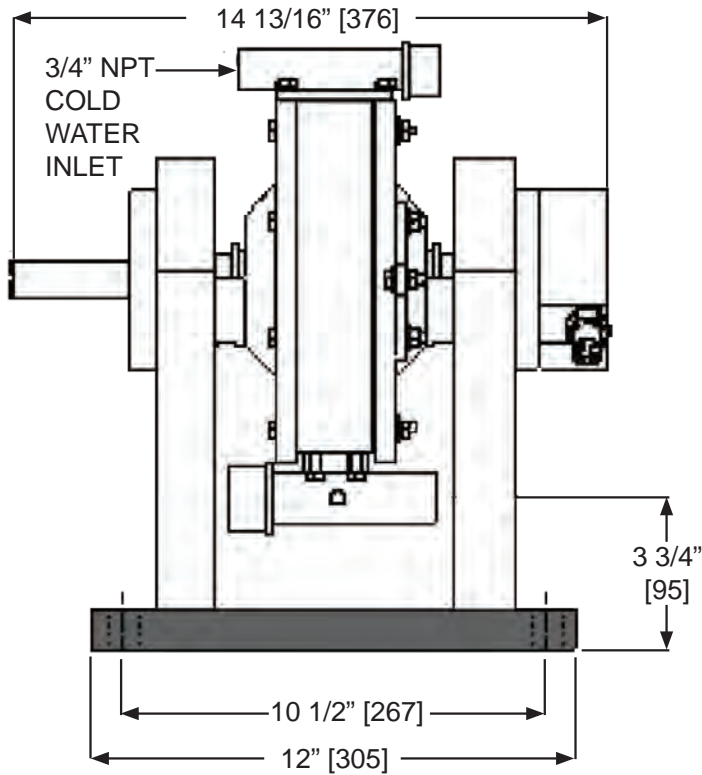

### Specifications

- Power: 50 hp (37 kW)
- Torque: 68 ft-lb (92 N)
- Speed: 6,000 rpm
- Water Use: 10 gpm (38 lpm) (No Cooling System)
- Shipping Weight: 150 lb (68 kg)

*Everything you need to succeed*



3602 West Wheelhouse Road, Milwaukee, Wisconsin 53208 U.S.A.  
 (414) 755-0040 [www.taylordyno.com](http://www.taylordyno.com)

SMS2042v002