

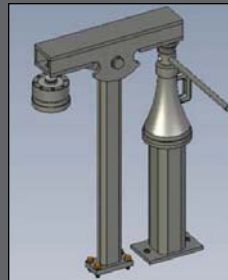

# High Torque Calibration Kit

# High Torque Calibration Kit

- Calibration Ball
- Calibration Load Cell
- Load Cell Mount
- Dynamometer Load Cell



High Torque Calibration Kit parts illustration.

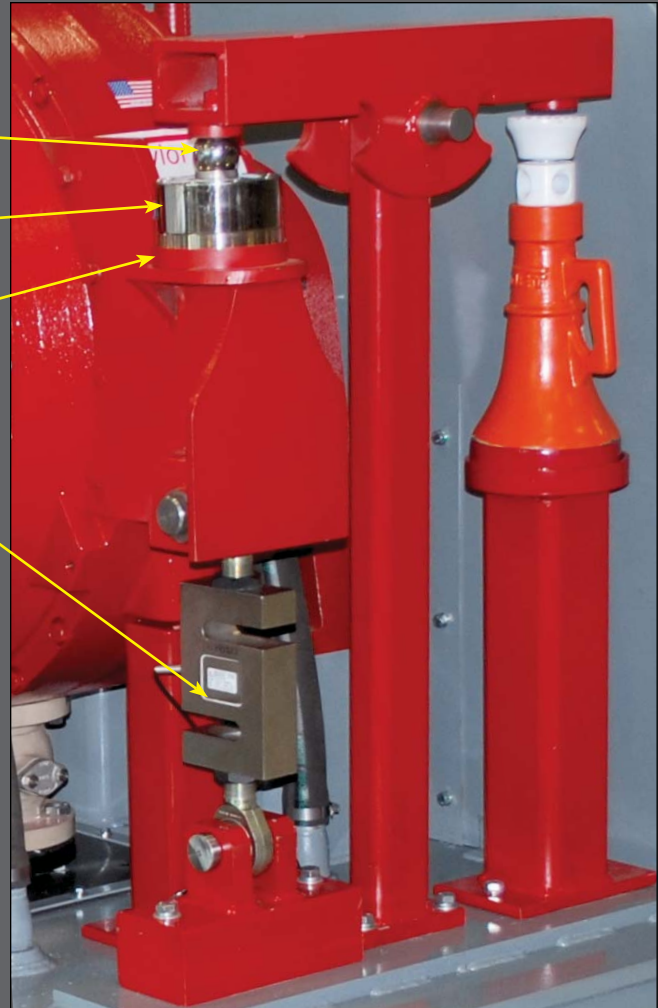

The High Torque Calibration Kit includes a transfer standard load cell with display (matched set), screw jack with turning bar and high torque calibration torque arm assembly eliminating the need for the bulky weights. The kit is designed for use with new DL, DS and DX series engine dynamometer & sub-base purchases. It is not designed for field retrofit to older units however with a new sub-base purchase for an existing DL, DS or DX series dynamometer it is a simple upgrade to accomplish.

The High Torque Calibration Kit provides the capability to calibrate your torque measurement system from 0-10,000 ft-lbs (0-13,558 Nm). As long as the Transfer standard load cell with display maintains a certified calibration (comes with calibration certificate when purchased) your dynamometer torque calibrations are traceable to a standard that can be easily verified.

SMS1145v001