



# M2 Dynamometer

# Engine Dynamometer



## Specifications

Power: 50 hp (37 kw)  
Torque: 68 ft. lbs. (92 Nm)  
Speed: 6000 RPM  
Water Use: 10 GPM (38 L/min) (No Cooling System)  
Shipping Weight: 150 lbs. (68 kg)

### Recommended Accessories:

- Driveshaft
- Shaft Guard
- Test Stand
- Throttle Control
- Data Acquisition & Control System
- Water Recirculating System

## M2 (English)



## M2 (Metric)

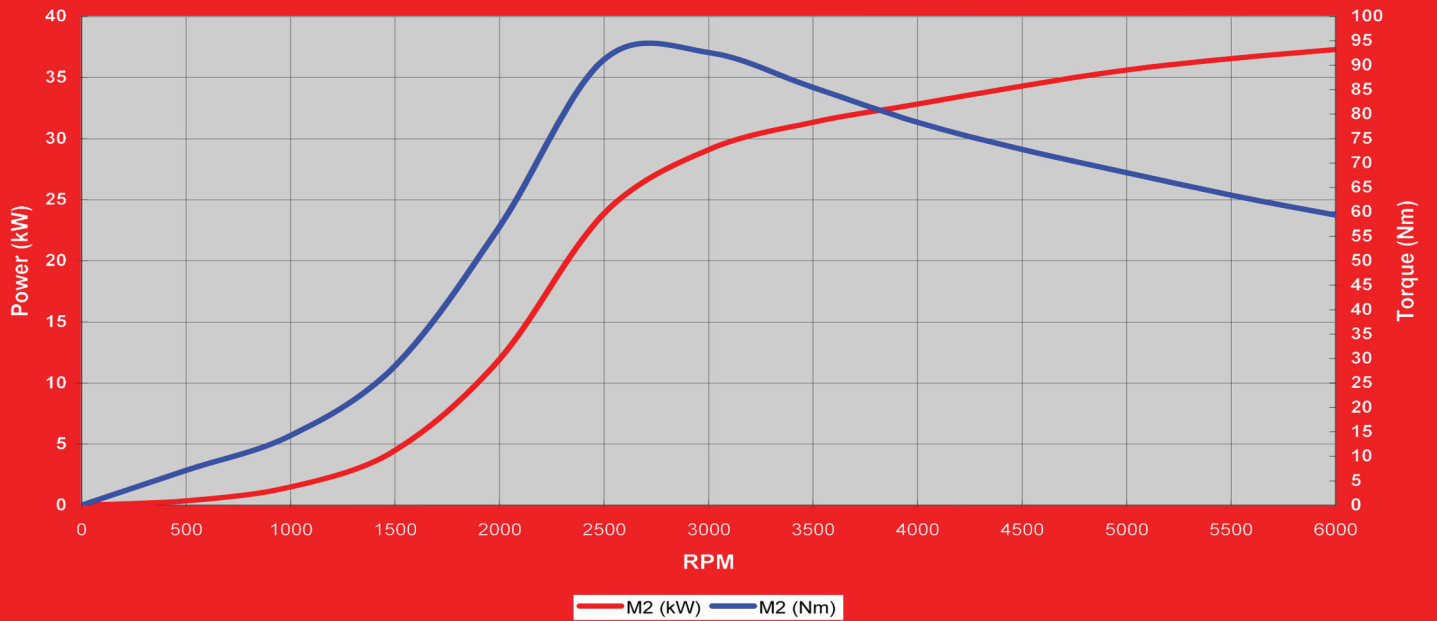

# M2

# Engine Dynamometer

Taylor Dynamometer

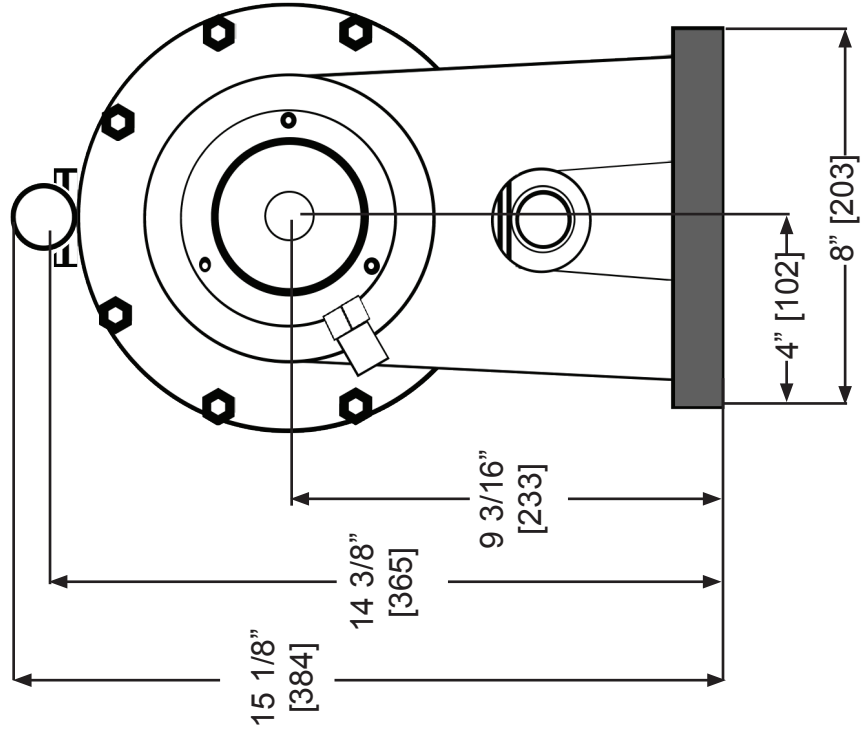
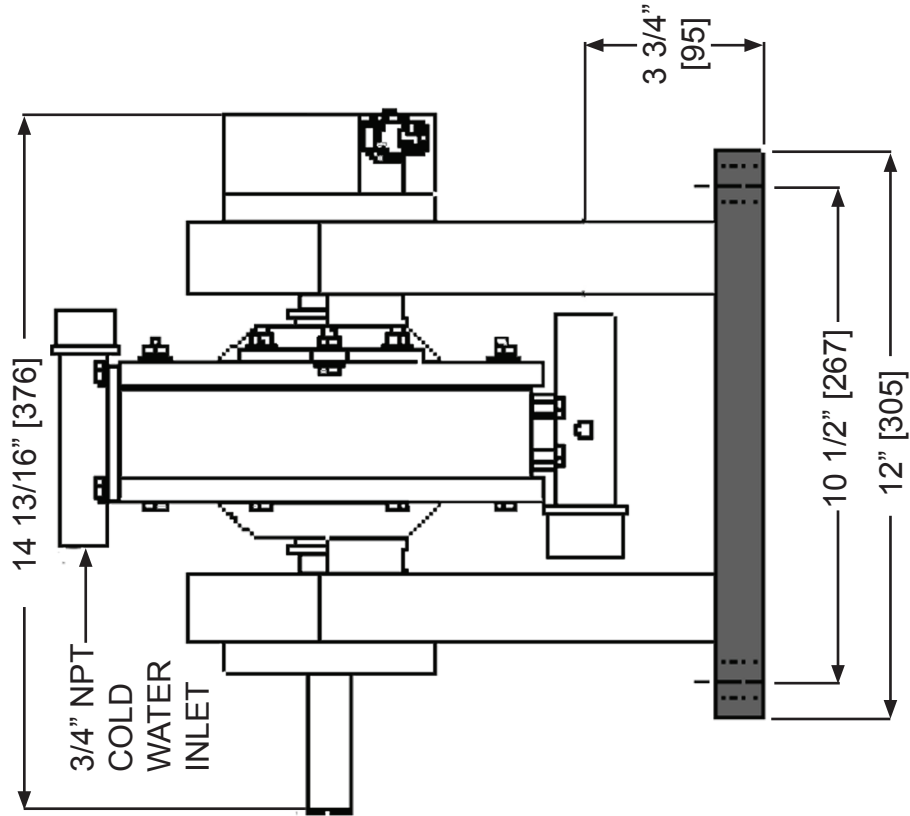

POWER: 50 hp (37 kw)  
 TORQUE: 68 ft. lbs. (92 Nm)  
 SPEED: 6000 RPM  
 WATER USE: 10 GPM (38 L/min) (No Cooling System)  
 SHIPPING WEIGHT: 150 lbs. (68 kg)

SMS0905V004

3602 West Wheelhouse Road, Milwaukee Wisconsin U.S.A  
 www.taylordyno.com 414-755-0040